



# M140005

## Fore/Aft Frame Engaging Adapters

**IMPORTANT**

This is only a supplement to the Operation Manuals shipped with your lift. Not intended to be a comprehensive Operation and Safety overview.



I  
N  
S  
T  
A  
L  
L  
A  
T  
I  
O  
N  
-  
S  
A  
F  
E  
T  
Y  
-  
O  
P  
E  
R  
A  
T  
I  
O  
N  
-  
M  
A  
I  
N  
T  
E  
N  
A  
N  
C  
E

Slide Fore/Aft Frame Engaging Adapter onto lift as shown in Fig. 1.

Rotate Latch Levers to engage the lift and lock the adapter into position, Fig. 2.

NOTE: When using extended forks you'll need to move the Latch Levers to the outer holes as shown in Fig. 3.

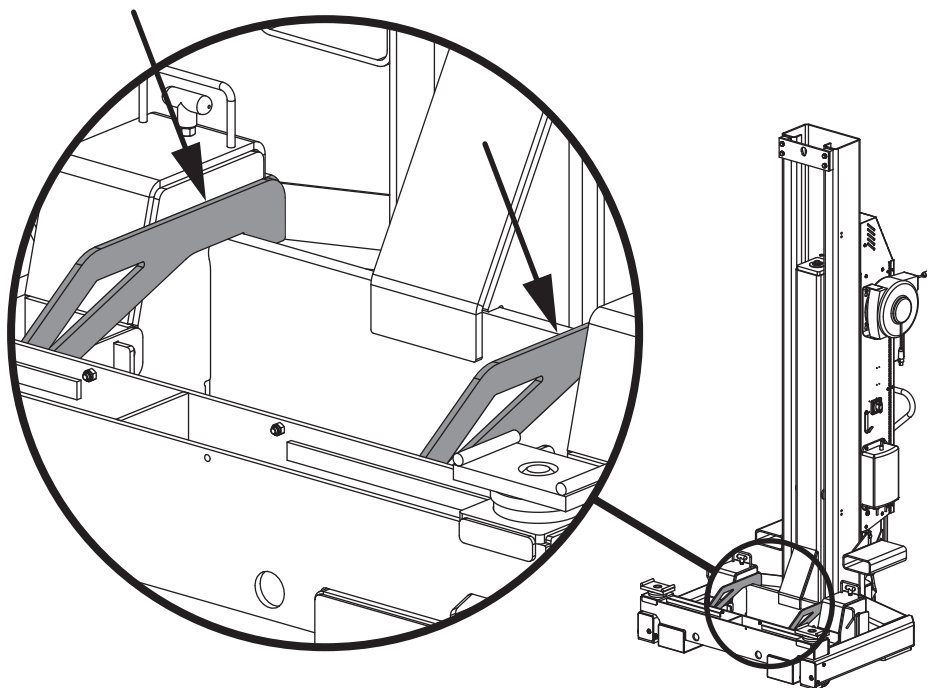
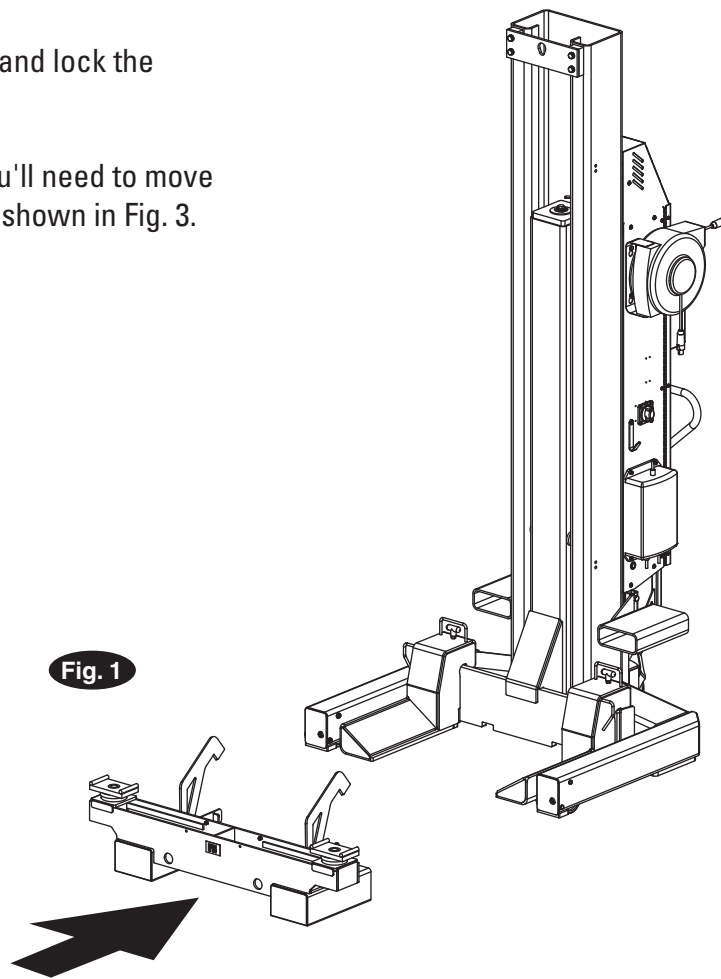

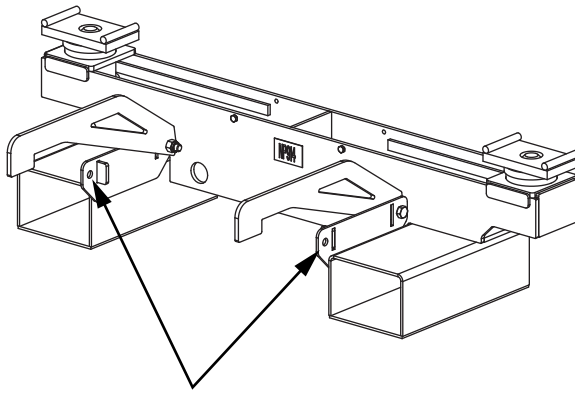

**Fig. 3**

If using with optional extended forks, you'll need to move latch levers to outer holes. Tighten bolts/nuts until snug, then back off 1/4 turn.

**Operation/Usage:** Raise vehicles up by the front and rear of the vehicle. **Never raise just one end of the vehicle.**

**Never exceed rated capacity: 7500 lbs. per column.**

Adjust adapters until you can make contact with the frame as shown below.

Ensure adapters have proper frame engagement. Frame should be centered with lift to help prevent offset loading.

Raise pair of lifts until tires clear the floor by approx. 6".

Shake vehicle moderately to ensure it is stable on lift.

Operate lifts. Always use safety stands as needed or when installing or removing heavy components.

**Refer to operating instructions supplied with lift for proper lifting procedures.**

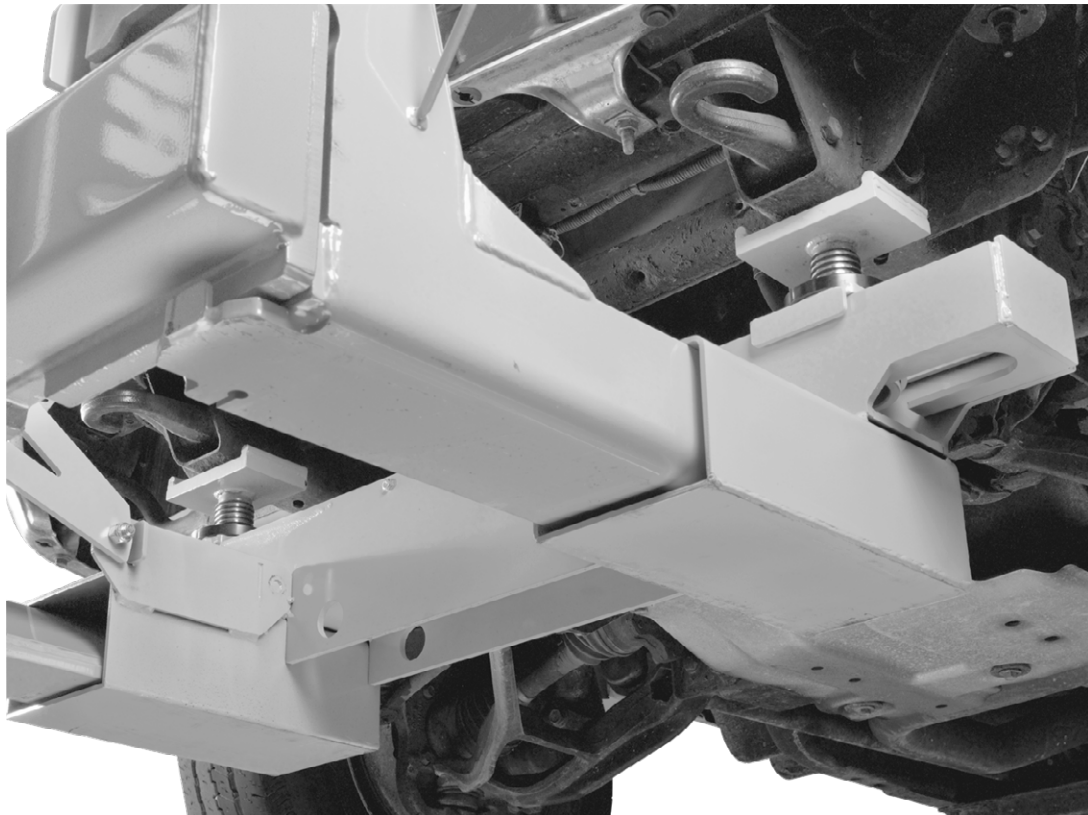

**Installer:** Please return this booklet to literature package, and give to lift owner/operator.

***Thank You***

**Trained Operators and Regular Maintenance Ensures Satisfactory Performance of Your Rotary Lift.**

**Contact Your Nearest Authorized Rotary Parts Distributor for Genuine Rotary Replacement Parts. See Literature Package for Parts Breakdown.**

**Rotary World Headquarters**

2700 Lanier Drive  
Madison, IN 47250, USA  
[www.rotarylif.com](http://www.rotarylif.com)

**North America Contact Information**

Tech. Support: p 800.445.5438  
f 800.578.5438  
e [userlink@rotarylif.com](mailto:userlink@rotarylif.com)  
Sales: p 800.640.5438  
f 800.578.5438  
e [userlink@rotarylif.com](mailto:userlink@rotarylif.com)

**World Wide Contact Information**

World Headquarters/USA: 1.812.273.1622  
Canada: 1.905.812.9920  
European Headquarters/Germany: +49.771.9233.0  
United Kingdom: +44.178.747.7711  
Australasia: +60.3.7660.0285  
Latin America / Caribbean: +54.3488.431.608  
Middle East / Africa: 1.812.273.1622

© Rotary®, Printed in U.S.A., All Rights Reserved. Unless otherwise indicated, ROTARY, DOVER and all other trademarks are property of Dover Corporation and its affiliates.



A **DOVER** COMPANY

